

**AHRI** CERTIFIED®  
www.ahrirectory.org

Central Station Air-Handling Unit Casings  
AHRI Standard 1350

**DRI® FLEXAIR™**

Air Handling Unit (DAHU)



**DRI Air Handling Unit systems are designed to ensure excellent Indoor Air Quality, effective Humidity Control, and maximum Energy Savings.**

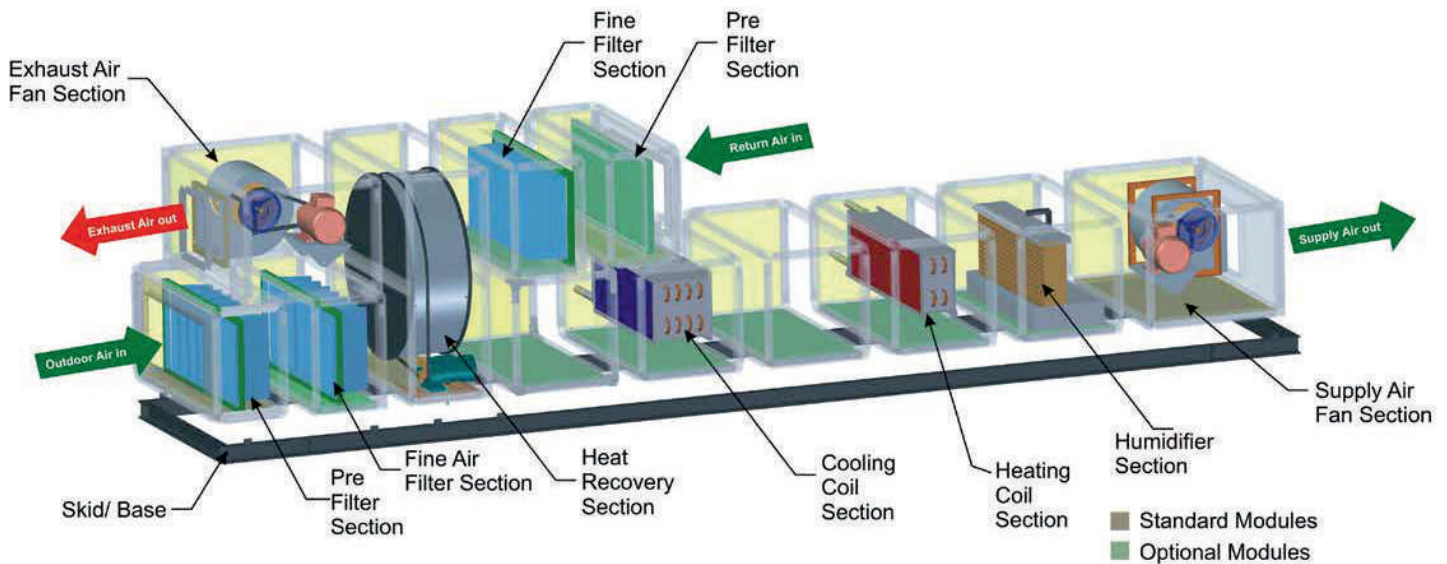

- **New Modular Design:** DAHU series air handling units are manufactured in modular sections. Units are normally shipped with each section fully assembled in the factory. The unit is however designed to be supplied in knockdown arrangement for quick site assembly, where shipping or plant room restrictions demand.
- **Highly Reliable Operation:** Assured problem free operations even under tough circumstances as a result of solid construction with tight sealing between supply and exhaust air ensures minimal leakage.
- **Space Saving Design:** Compact design integrating all components in a single unit.
- **Best Technology in Casing Manufacturing:** The DAHU is manufactured in accordance with the best technology incasing manufacturing. With 0.8 mm sheet on inside and out side, the design is very sturdy and results in better lower leakage class.
- **Uniquely Designed Connection system:** The unique design makes it possible for the assembler to choose from two different ways of connection when he assembles the unit in the machine room in concealed PG joints and flange connections with strips.
- **Insulation Material and Wall Construction:** Double skin construction is provided by "sandwich" type 45/50mm THK panels comprising 0.8mm thick outer PPGI steel sheet, inner 0.8mm Galvanized steel sheet and polyurethane foam insulation with 40kg/m<sup>3</sup> density, providing a thermal conductivity coefficient of 0.0213W/m-k.

- **High quality standardised filters:** Deep folded bag filters with big filter areas and good sealing. The good tightness ensure clean air supply to the room is of high quality. Tool free access for easy cleaning.
- **Very low pressure drops:** All functions like coils, heat exchangers etc. are optimised to give lowest possible pressure drop in proportion to highest possible efficiency resulting in very low LCC.
- **Easy to maintain fan assembly:** Tool free access to fan assembly. Fan assembly slides out for servicing with a quick disconnect system. Saves time and money ! Reliable solid transmission construction saves belts and bearing.
- **Time tested reliability:** The DAHU is the manifestation of DRI's experience in the field of air handling technology and over 200 man years of R&D and experience in manufacturing the world class Energy Recovery Wheels.
- **Designed as per highest AHRI Standard for Casing Construction:** The casing construction is of prime importance in two tier systems i.e. Systems with two streams with high latent difference between both.

DAHU is manufactured to meet AHRI 1350 Standard requirements as given the following rating.

- **Casing Deflection Rating Class: CD4**
- **Casing Air Leakage Class: CL1**
- **Thermal Transmittance Class with Leakage: CT2**
- **Thermal Bridging Class: CB2**
- **Widest Range:** The DAHU series double skin air handling unit (AHU) consists of 15 models having air volumes ranging from 1700 -60000 CMH and internal static pressures as high as  $\pm 1000\text{pa}$ , to ensure maximum flexibility and the best solution for your application.

DAHU air handling unit uses special extruded aluminum & pvc profile corner post which break the thermal bridge, reinforced plastic traixial lug, flush fitting panels and doors, and has a smooth surface and attractive profile.

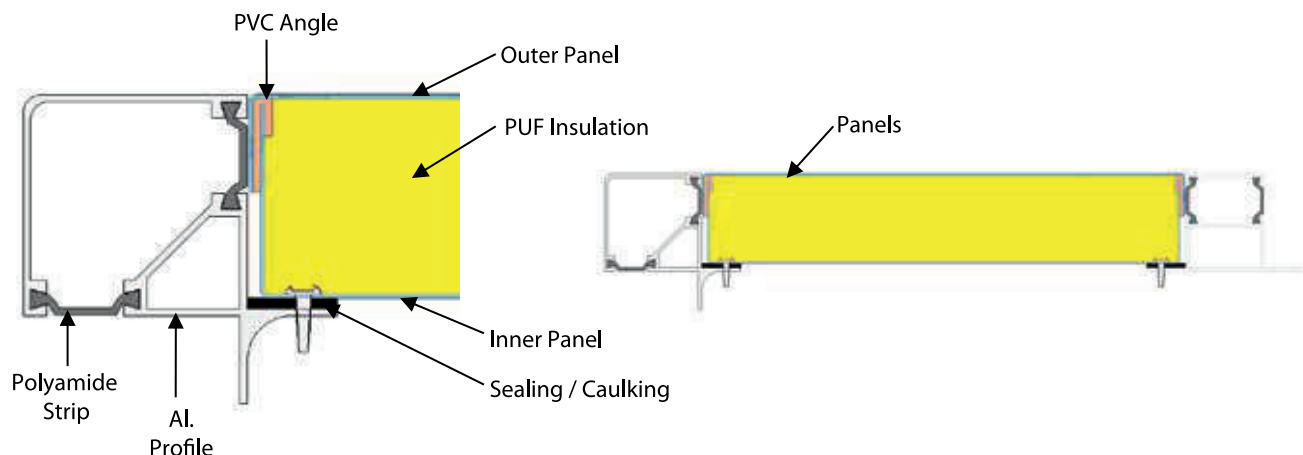

**All sizes of the FlexAir (except size 060 and 100) has filters in standard dimensions making maintenance and stocking of spare filters easier. A big advantage for customers those who wish to keep a stock of filters.**



## Model Series

→ DRI Air Handling Unit (DAHU)

XX → Air flow

- 1700 CMH
- 3500 CMH
- 5000 CMH
- 7000 CMH
- 8500 CMH
- 10000 CMH
- 12000 CMH
- 17000 CMH
- 20000 CMH
- 25000 CMH
- 30000 CMH
- 35000 CMH
- 40000 CMH
- 50000 CMH
- 60000 CMH

## DAHU Dimension Detail

S. No.	Unit Model	Air Volume	Unit Dimension (in mm)											Cross Sectional
		CMH	L	L1	L2	L3	L4	W	H	H1	H2	A	B	Area
1	DAHU-1700	1700	2972	685	455	1135	685	905	1195	1120	560	500	300	4.0
2	DAHU-3500	3500	2972	685	455	1135	685	1035	1195	1120	560	700	300	4.6
3	DAHU-5000	5000	3272	835	455	1135	835	1185	1575	1500	750	800	500	7.6
4	DAHU-7000	7000	3572	985	455	1135	985	1415	1600	1500	750	1000	500	9.2
5	DAHU-8500	8500	3572	985	455	1135	985	1415	1820	1720	860	1000	600	10.8
6	DAHU-10000	10000	3572	985	455	1135	985	1630	1820	1720	860	1200	600	12.5
7	DAHU-12000	12000	4172	1285	455	1135	1285	1685	2190	2090	1045	1200	800	16.1
8	DAHU-17000	17000	4172	1285	455	1135	1285	2005	2190	2090	1045	1400	800	19.4
9	DAHU-20000	20000	4172	1285	455	1135	1285	2215	2400	2300	1150	1600	800	23.9
10	DAHU-25000	25000	4622	1460	555	1135	1460	2350	2930	2780	1390	1600	1000	28.8
11	DAHU-30000	30000	5007	1585	690	1135	1585	2550	2930	2780	1390	2200	1000	31.4
12	DAHU-35000	35000	5307	1735	690	1135	1735	2750	3510	3360	1680	2200	1200	42.2
13	DAHU-40000	40000	5607	1885	690	1135	1885	2950	4230	4080	2040	2400	1600	56.4
14	DAHU-50000	50000	5907	2035	690	1135	2035	3150	4230	4080	2040	2400	1600	60.4
15	DAHU-60000	60000	6207	2185	690	1135	2185	3350	4550	4400	2200	2600	1800	70.0

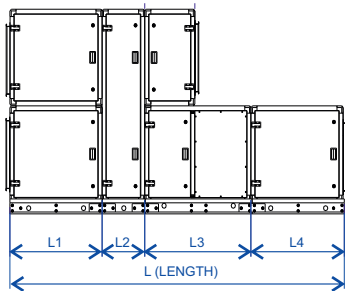

NON STACKED AHU

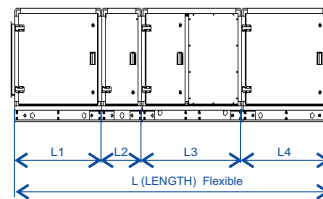
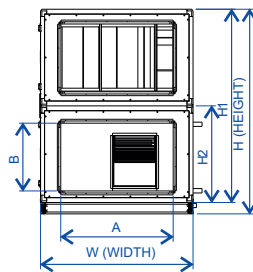

NON STACKED AHU

